

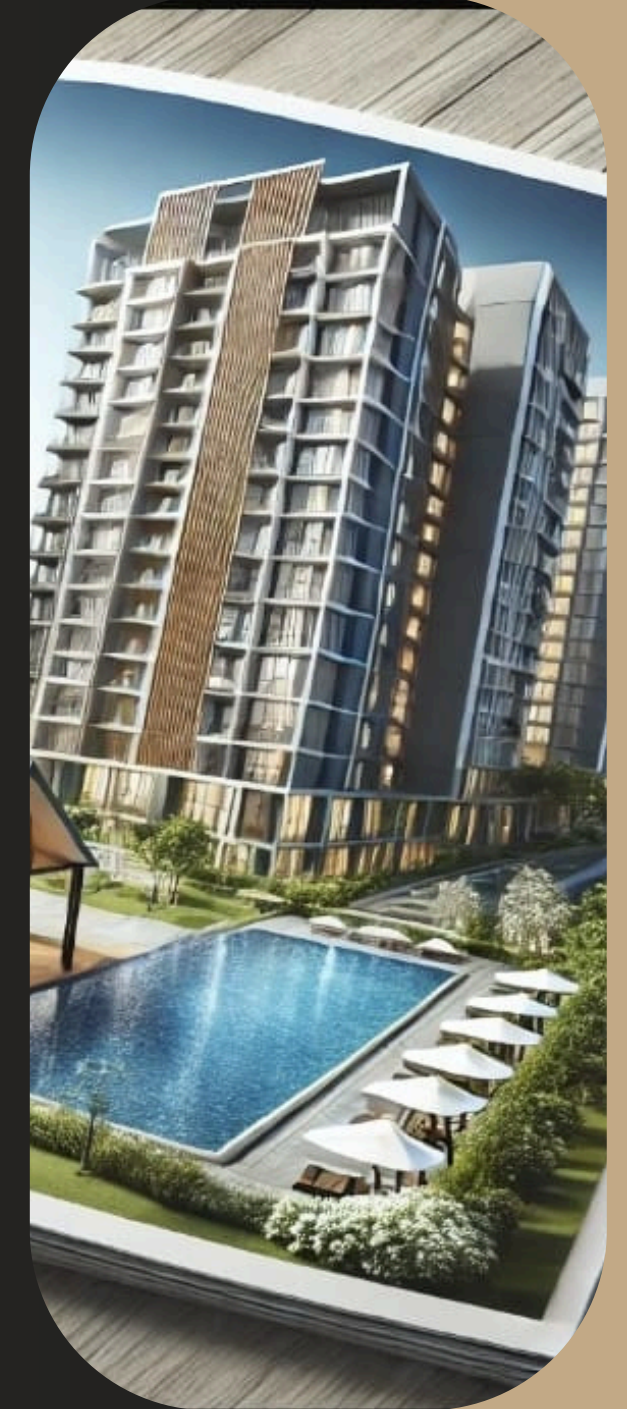

# PRIME BUILDERS

The art of living  
Safe secure assure

[www.primebuilders.info](http://www.primebuilders.info)





**Property Management:** This service involves overseeing and maintaining properties on behalf of owners, including rent collection, tenant screening, maintenance, and repairs.

**Real Estate Brokerage:** Real estate brokers facilitate buying and selling transactions between buyers and sellers. They provide market analysis, pricing guidance, and negotiation services to clients.

**Property Valuation and Appraisal:** This service involves determining the value of a property for various purposes, such as buying, selling, taxation, or financing.

**Real Estate Investment Advisory:** This service provides guidance to investors on real estate investment opportunities, including market research, due diligence, and portfolio management.



## MISSION & VISION

"Our mission is to deliver exceptional real estate experiences by providing personalized service, expert knowledge, and innovative solutions to our clients, while fostering a culture of integrity, teamwork, and community involvement."

"Our vision is to be the leading real estate company in the region, renowned for our commitment to excellence, customer satisfaction, and community development. We strive to create a better future for our clients, employees, and the communities we serve, by providing innovative and sustainable real estate solutions that enhance lives and build prosperity."





**Real estate encompasses the buying, selling, renting, and development of properties, including residential, commercial, industrial, and agricultural land. It offers a tangible asset class, diversification, and potential long-term wealth creation through rental income, appreciation, and tax benefits. Real estate markets are influenced by factors like location, economic conditions, demographics, and government policies. Investors can participate through direct property ownership, real estate investment trusts (REITs), real estate mutual funds, and real estate crowdfunding platforms, each offering varying levels of risk, return, and liquidity.**



# WE DEAL ON



COMMERCIAL



RESIDENTIAL



AGRICULTURE



FARMHOUSE

PHASE 01 - LIVE NOW

PHASE 02 - COMING SOON





Let's Start  
Super dealer income  
start on minimum  
1000 unit and above

**BUY NOW**



# TYPES OF INCOME

**01 | DEALER COMMISSION**

**02 | BOOSTER INCOME**

**03 | RENTAL INCOME**

**04 | D TO D INCOME**

**05 | ROYALTY INCOME**

**06 | LOYAL INCOME**





# DEALER INCOME



**4%**

**You Receive 4% Deal  
Commission Income or Direct  
Referral Income**







## **SUPER DEALER INCOME**

**2%**



## **SUPER DEALER DIRECT INCOME**

**1%**





# BOOSTER INCOME



**Income Unit  
Price  
Increase 10%  
upto 100%**





# RENTAL INCOME



**FIRST 6  
MONTH  
0.1%  
PER DAY**

**NEXT 3  
MONTH  
0.15%  
PER DAY**

**NEXT 2  
MONTH  
0.2%  
PER DAY**





# D TO D INCOME



LEVEL	INCOME
Level 01	10%
Level 02 - 05	5%
Level 06 - 10	3%
Level 11 - 15	1%





# ROYALTY INCOME



DIRECT	NEXT TO NEXT	PER MONTH (10 MONTH)	TOTAL INCOME
03	2,00,000 +	1000/-	10,000/-
05	5,00,000 +	2000/-	20,000/-
10	10,00,000 +	5000/-	50,000/-
15	20,00,000 +	10000/-	1,00,000/-
20	30,00,000 +	20000/-	2,00,000/-
25	50,00,000 +	30000/-	3,00,000/-
30	1,00,00,000 +	50000/-	5,00,000/-
35	1,50,00,000 +	100000/-	10,00,000/-
40	2,00,00,000 +	150000/-	15,00,000/-
45	3,00,00,000 +	200000/-	20,00,000/-
50	5,00,00,000 +	250000/-	25,00,000/-





# LOYAL INCOME



**For our  
valuable  
Group 0005  
team Members**





# TERMS & CONDITIONS



1. Any time withdraw your full payment, Not applicable on super dealer income
2. If you withdraw your full payment before six months booster income, not included.
3. After six months, you get profit booster income 50%.
4. After 11 month, you get 100% profit of booster income.
5. 2 Direct compulsory to get all income benefits.
6. 10% percent deduction on all income.
7. 24/7 support system.
8. Loyal income, any time after three month condition applied.
9. Withdraw your profit monthly.
10. Project wise unit price up and down.





**G05**  
**GROUP**  
**—005—**

**Thanks For Your Attention !!**

[www.primebuilders.info](http://www.primebuilders.info)